



Virginia Institute of Marine Science

Committee on Administration, Buildings & Grounds
September 26, 2019



VIMS Campuses



Main campus, Gloucester Point:

- Located at the mouth of the York River
- ~42 Acres
- 63 Buildings
- 374,221 SF



Field Laboratory, Wachapreague:

- Located on the seaside of the Eastern Shore
- ~5 Acres
- 24 Buildings
- 34,026 SF



Kauffman Aquaculture Center, Topping:

- Located on the Rappahannock River
- 1 Building
- 6,420 SF

Gloucester Point Campus



Wachapreague Campus



Topping Campus



Kauffman Estate

Kauffman Aquaculture Center



Construction Update

Active Capital Projects

Project	Type	Stage	Total Project Cost (\$ in M)
New Research Facility (Replace Chesapeake Bay Hall)	New Construction	Programming Complete Schematic Design in Progress	\$37.0
ESL Complex	Replacement	Working Drawings Phase Anticipate Breaking Ground December 2019	\$15.9
Acuff Center for Aquaculture (Replace Oyster Hatchery)	Replacement	Preliminary Design Complete Target Construction Start February 2020	\$19.8

New Chesapeake Bay Hall



ESL Complex

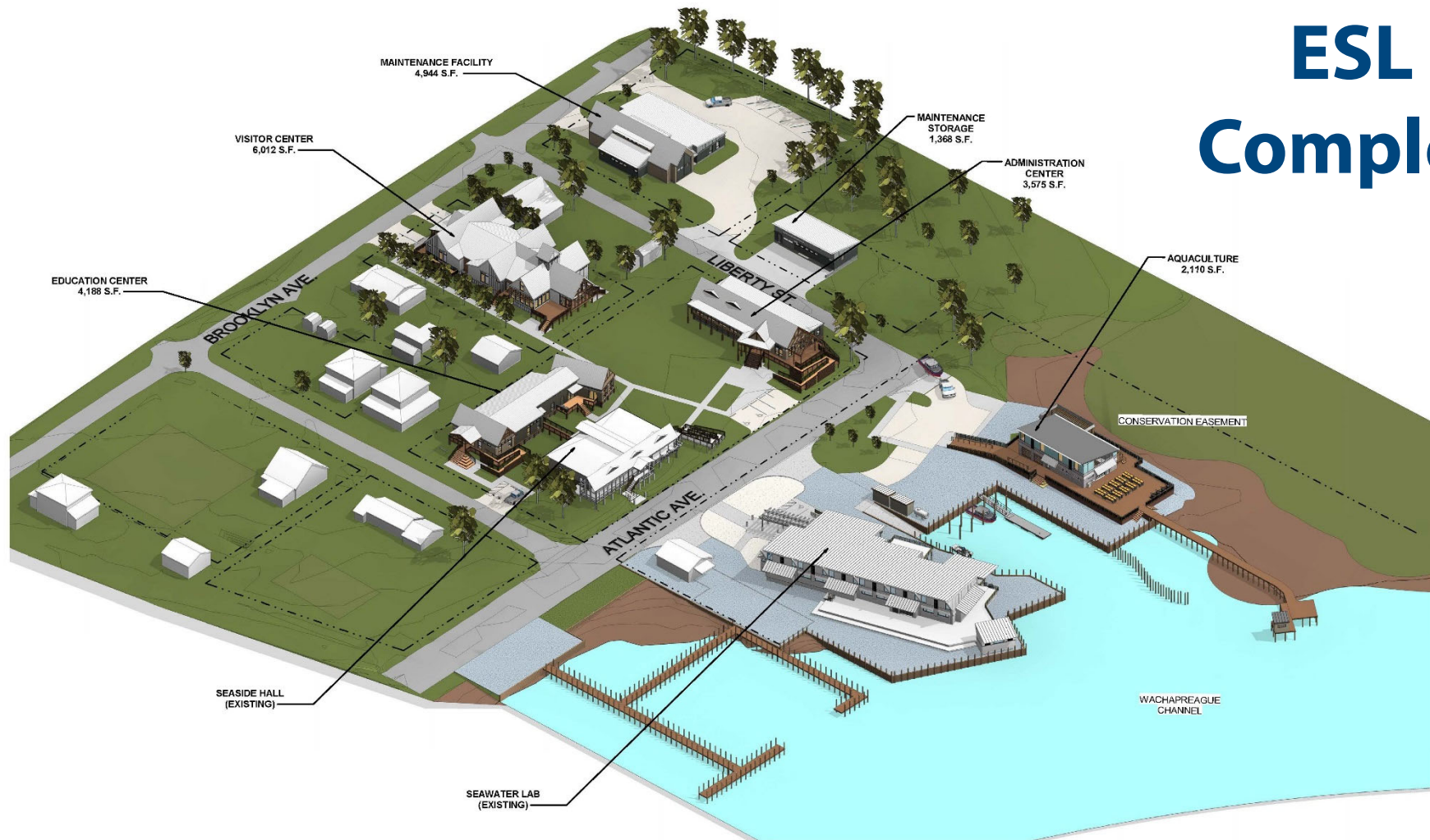

ESL Complex

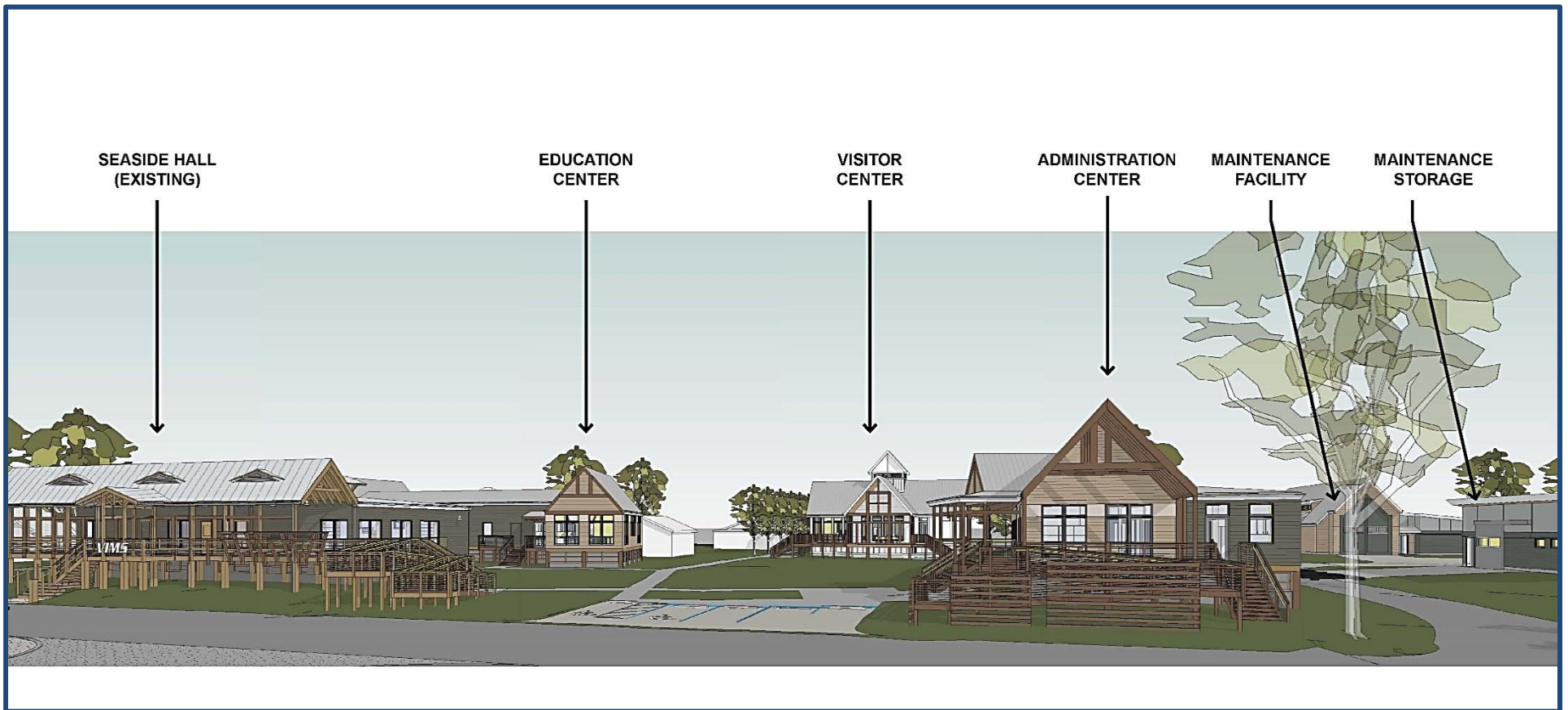

ESL Complex Continued



Acuff Center for Aquaculture



2019 Governor's Capital Budget Requests

Project	Type	Stage	Total Project Cost (\$ in M)
Fisheries Science Building	Replacement	38,000 SF Facility VIMS-Funded Feasibility Study Underway	\$30.0
Field Operations Complex	New Construction	10,000 SF Facility	\$6.6



Questions?