

# Richard Bland College of William & Mary

## Innovation Center

February 7, 2019



**RRMM**  
**ARCHITECTS**



**Richard Bland College**  
*of* WILLIAM & MARY







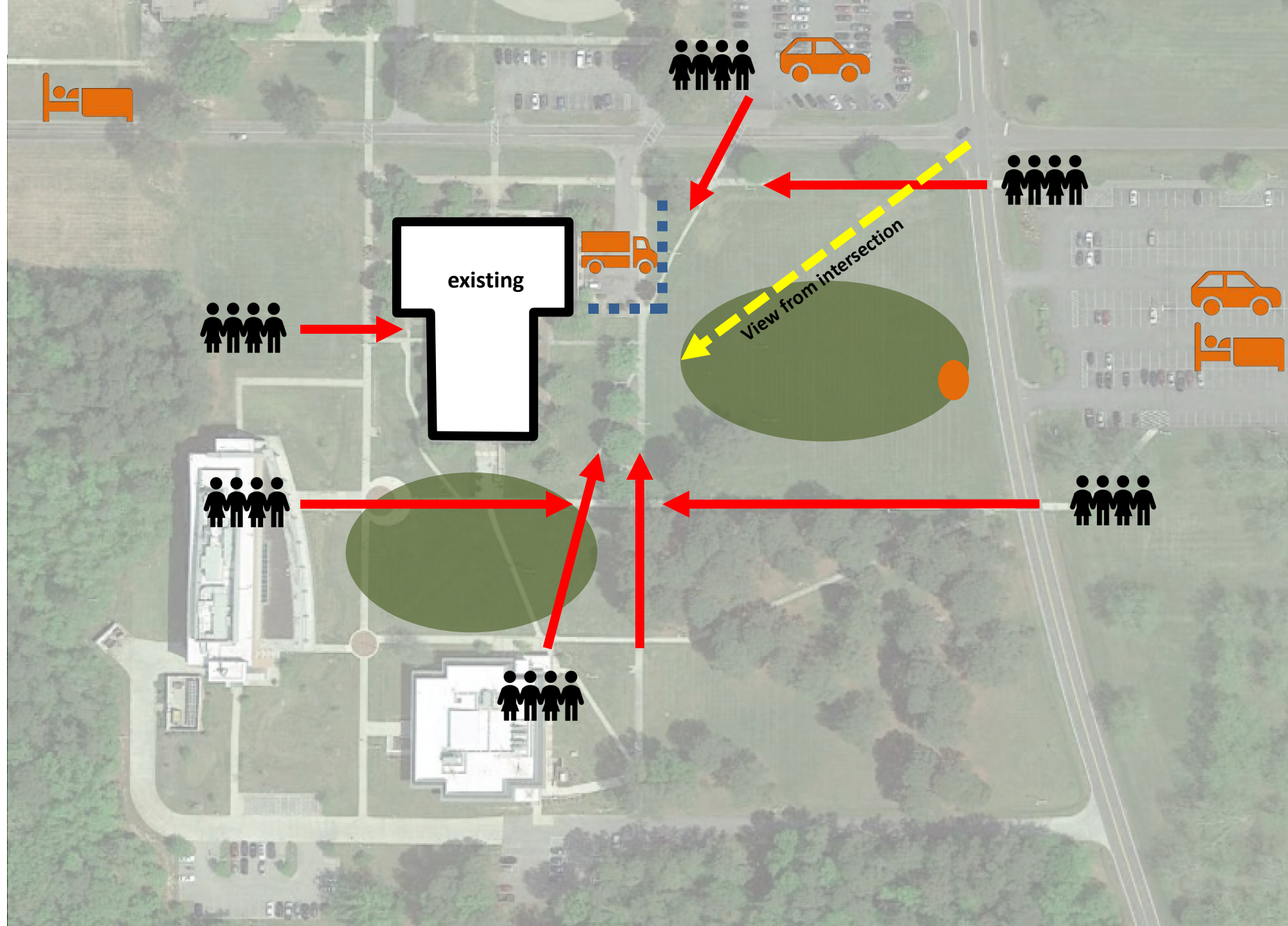

+ master plan context



+ design factors

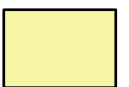

# + first floor plan

-  Entrances
-  Views
-  Visual Shielding
-  Building Services
-  Collaboration
-  Distance Learning
-  Cafe
-  Classroom
-  Circulation

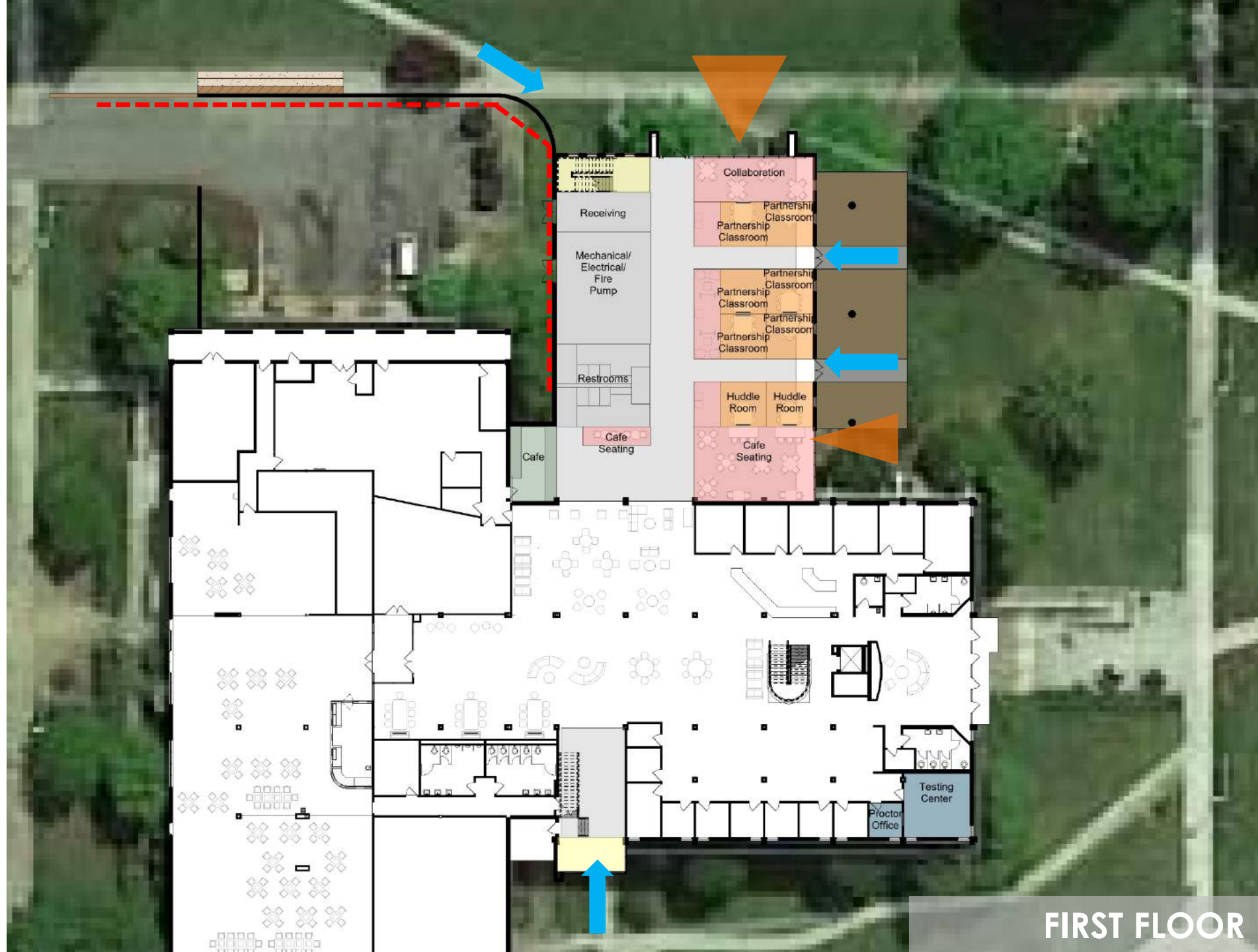

FIRST FLOOR

# + first floor program

## RBC Innovation Center Program

Room Name

Sq Footage

### First Floor

Partnership Classroom 1	149 SF
Partnership Classroom 2	149 SF
Partnership Classroom 3	149 SF
Partnership Classroom 4	149 SF
Partnership Classroom 5	149 SF
Partnership Classroom 6	149 SF
Huddle Room 1	149 SF
Huddle Room 2	149 SF
Café	249 SF
Collaboration Space	1,492 SF
Mech/ Elec/ Fire Pump/ Data	750 SF
Receiving/Loading	264
Restrooms	550 SF
Stair	233 SF
Circulation	1,858 SF

Total First Floor

6,588 SF

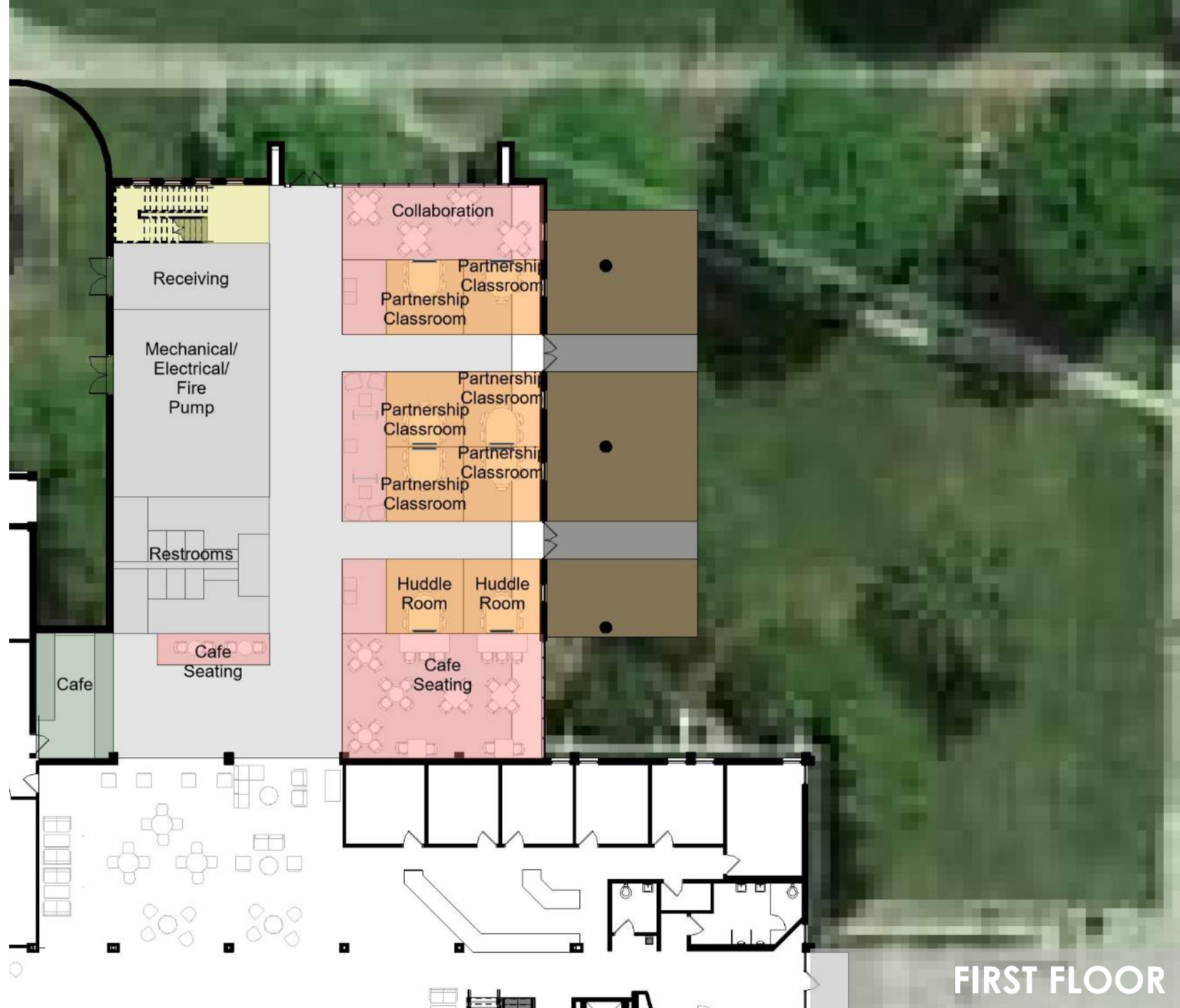

FIRST FLOOR

# + second floor plan



Views



Visual Shielding



Building Services



Collaboration



Distance Learning



Recording Studio



Classroom



Office/Conference



Existing Stacks



Special Collections



Circulation

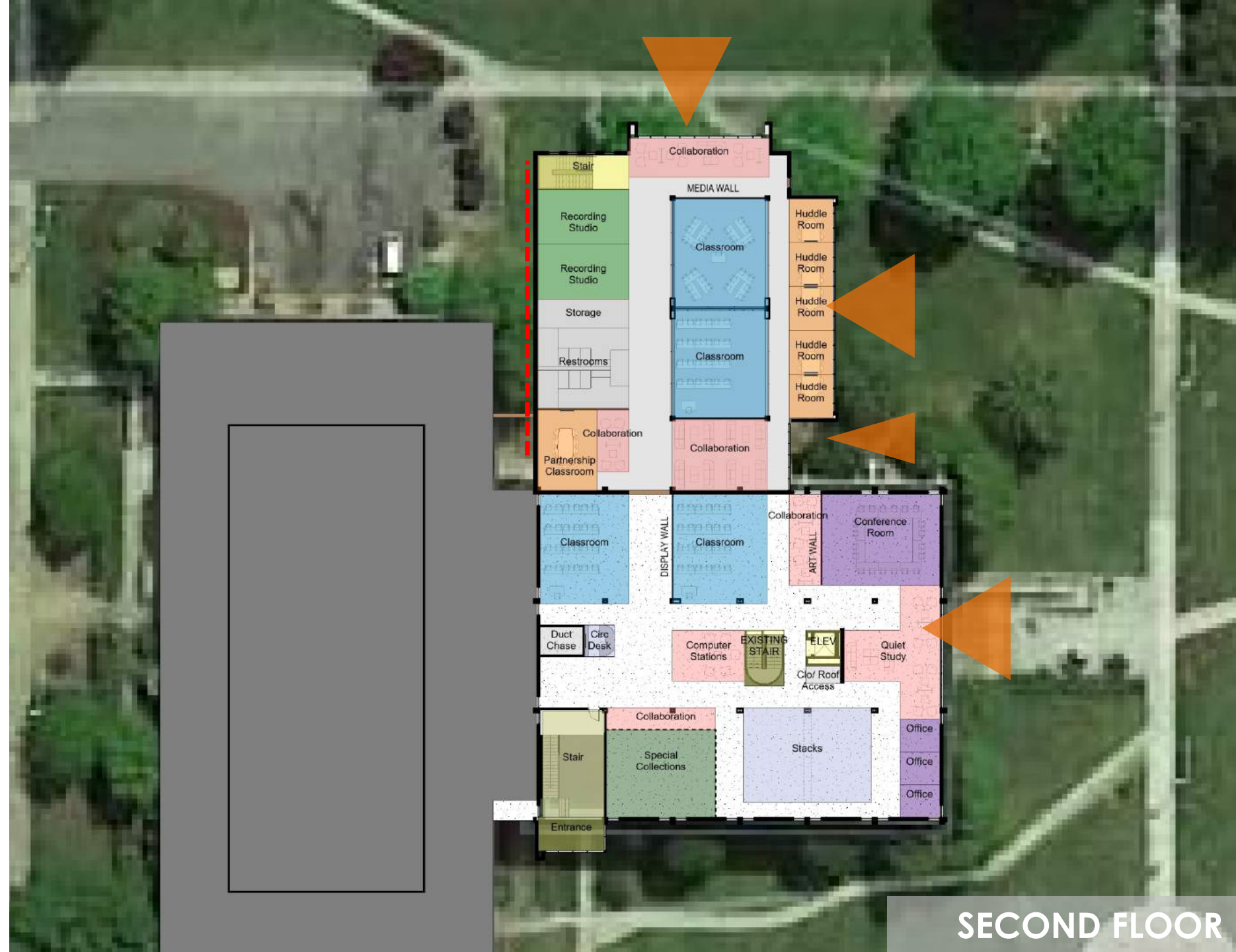

SECOND FLOOR

# + second floor program

## Second Floor (addition)

Classroom 1	780 SF
Classroom 2	780 SF
Huddle Room 3	144 SF
Huddle Room 4	144 SF
Huddle Room 5	144 SF
Huddle Room 6	144 SF
Huddle Room 7	144 SF
Partnership Classroom 7	365 SF
Recording Studio 1	375 SF
Recording Studio 2	375 SF
Collaboration Space	1,130 SF
Storage/Roof Access	200 SF
Restrooms	550 SF
Stair	233 SF
Circulation	1,666 SF

**Total Second Floor Addition**

**7,174 SF**

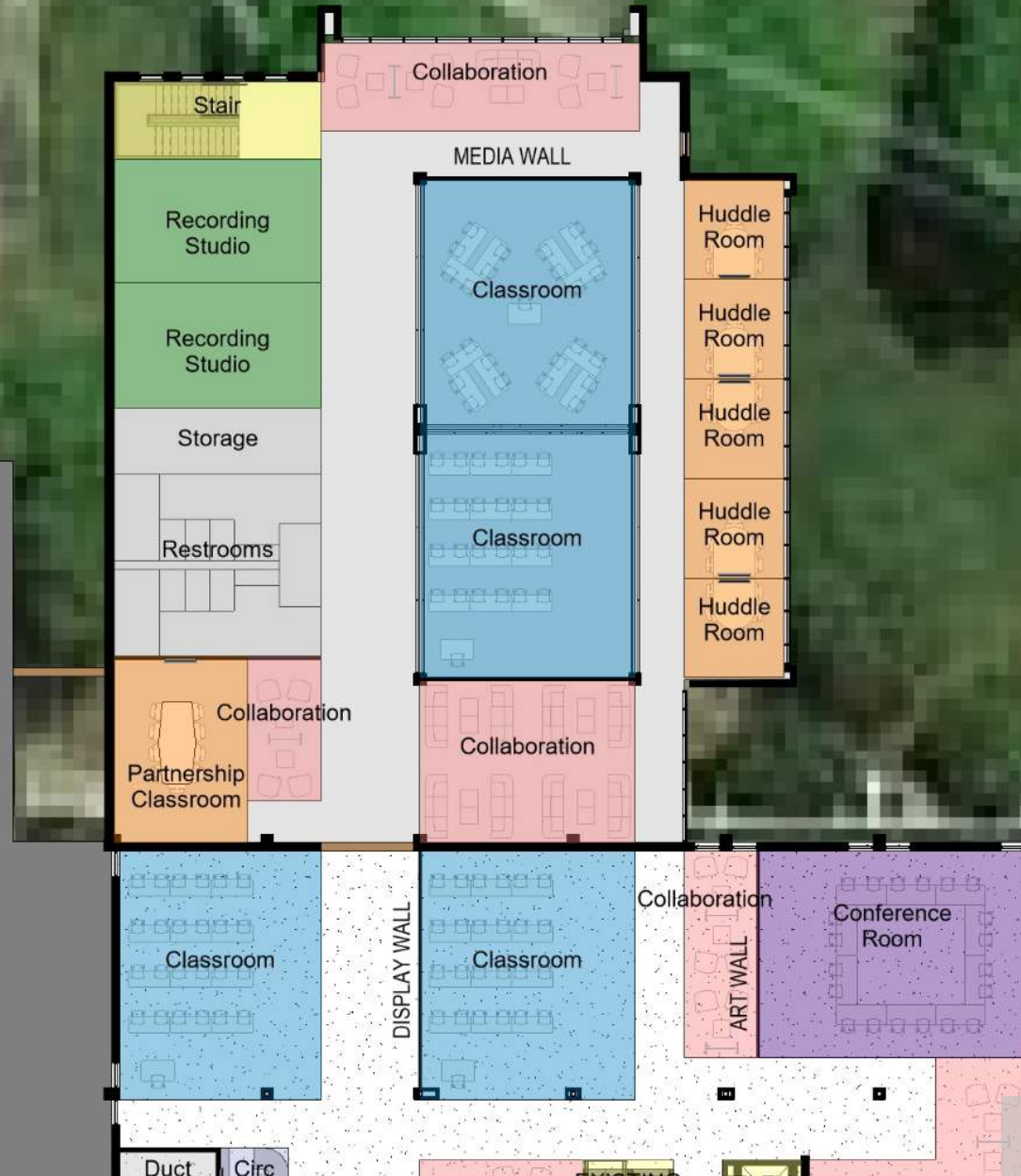

**SECOND FLOOR**

# + second floor program

## Second Floor (renovation)

Classroom 3	730 SF
Classroom 4	780 SF
Conference Room	809 SF
Office 1	99 SF
Office 2	99 SF
Office 3	99 SF
Collaboration	1,293 SF
Special Collections	720 SF
Stacks	913 SF
Circulation Desk	75 SF
Duct Chase	90 SF
Closet/ Roof Access	45 SF
Stair	493 SF
Existing Stair	469 SF
Existing Elevator	147 SF
Circulation	2,855 SF

**Total Second Floor Reno** 9,716 SF



SECOND FLOOR

+ existing aesthetic



**Ernst Hall / SSHE Building**

**McNeer Science Building**

Includes: Brick, Metal Panel,  
Precast, Columns, Sunshading,  
Glass (curtainwall & storefront),  
canopies, etc.)



+ massing study

2 Story (7,000 SF Each Floor)

New West Entrance

Screen Walls @ Loading Area for Dining

Floor 2 Library Renovation 10,000 SF

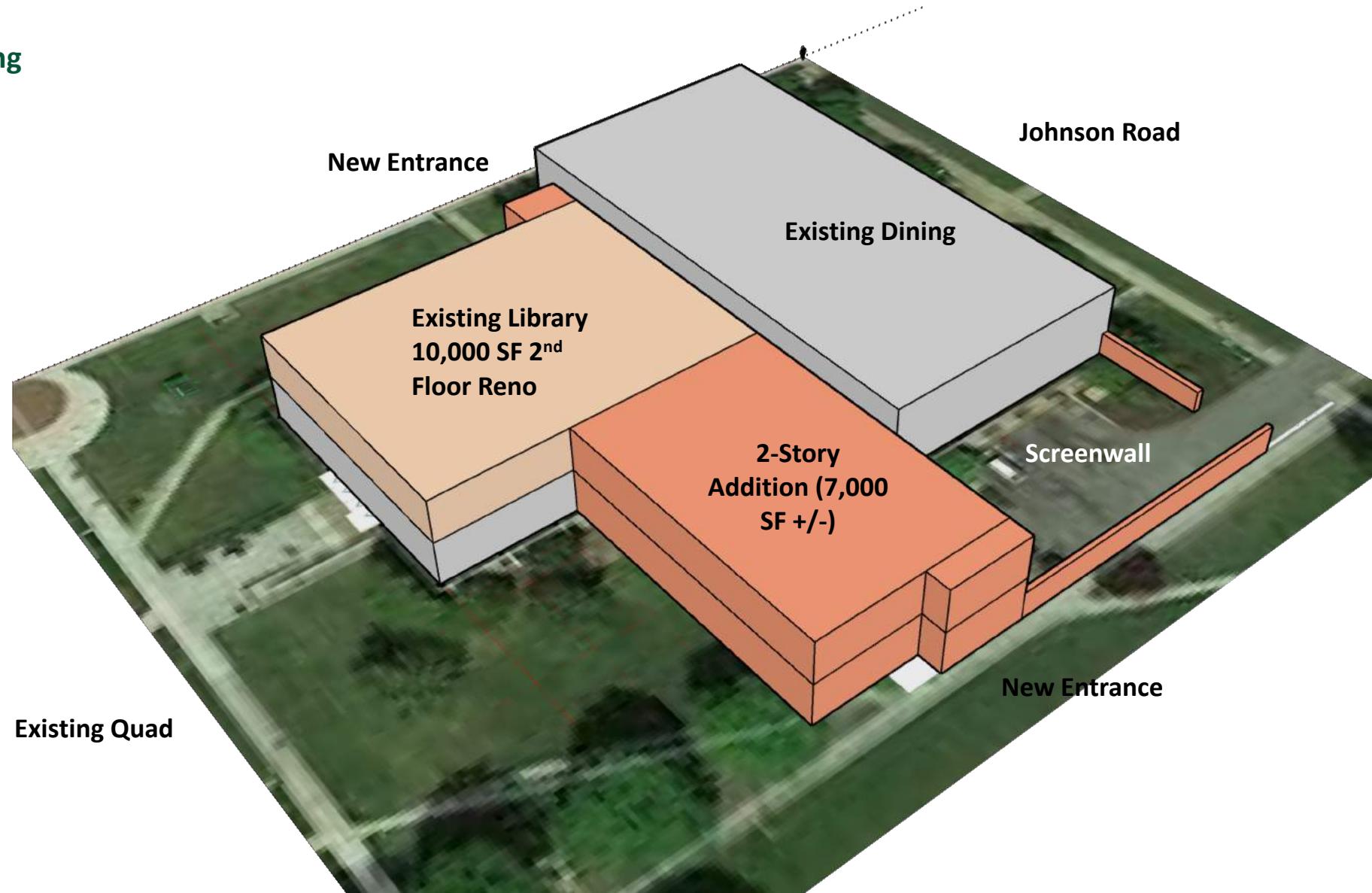

+ exterior form

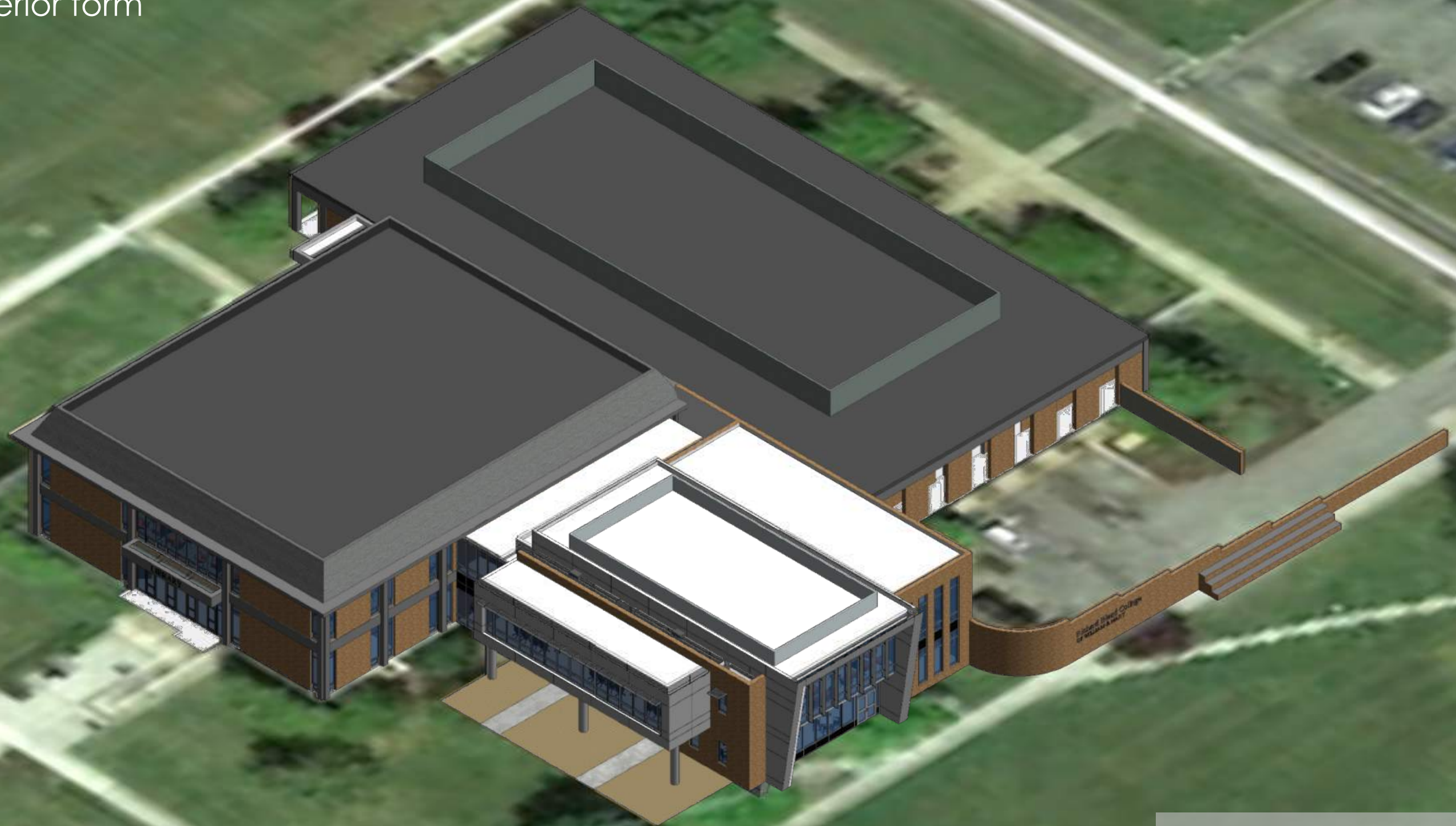

3D VIEW

+ exterior form



3D VIEW

+ exterior form



3D VIEW

+ exterior form – new entrance



3D VIEW

+ diagrammatic section

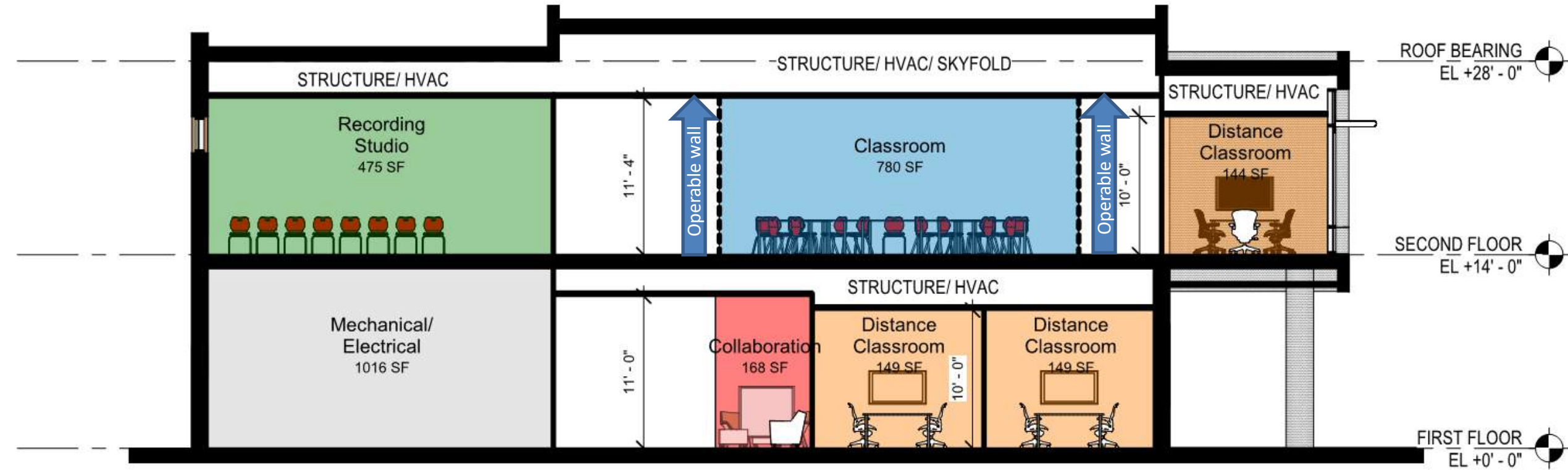

+ flexibility



SECOND FLOOR

+ movable partitions



+ flexibility

learning commons



active learning classrooms



+ modularity approach

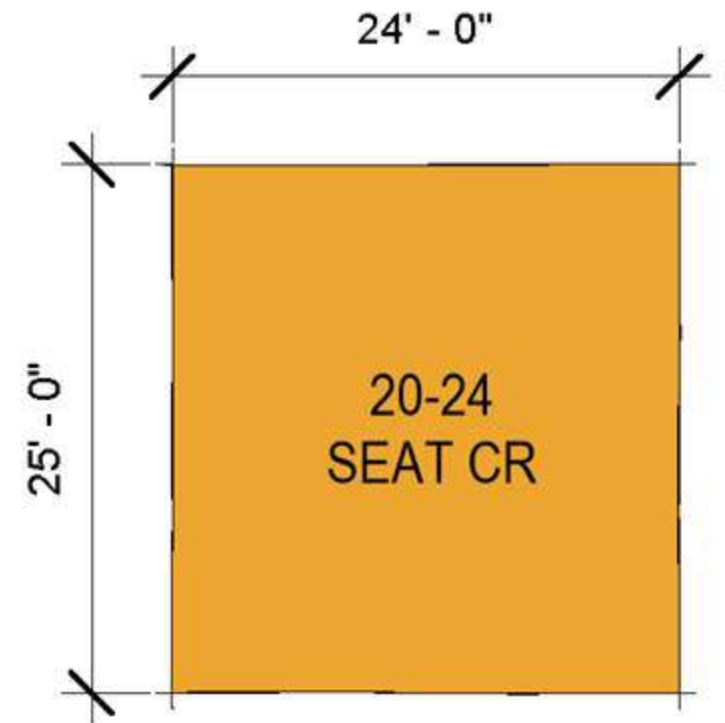
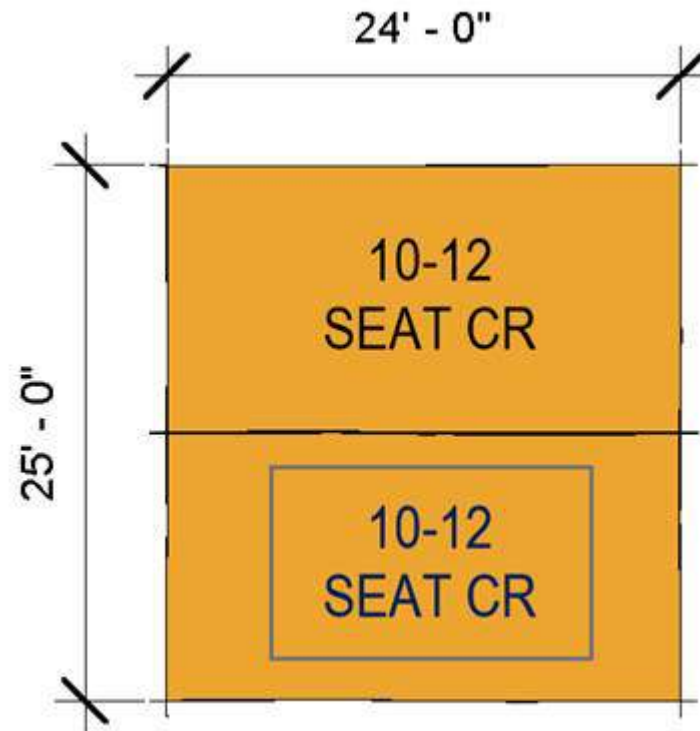
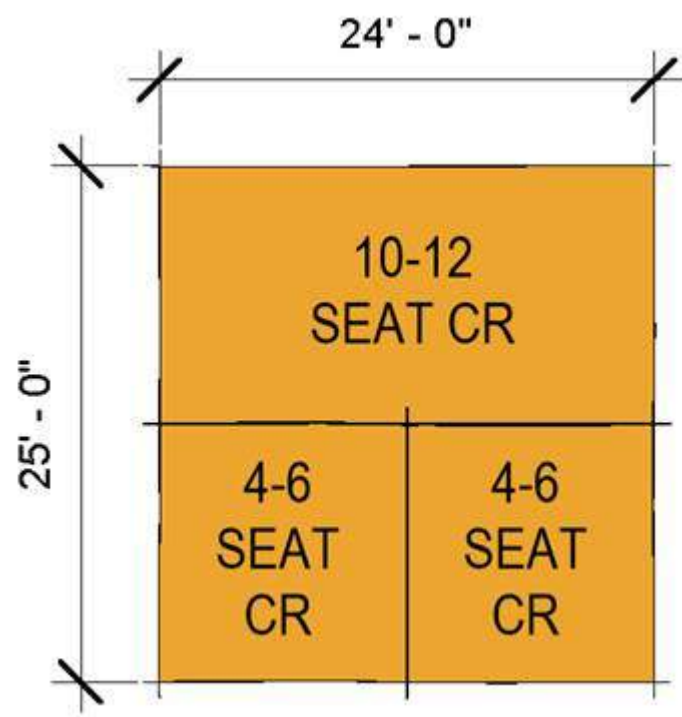

+ modularity approach

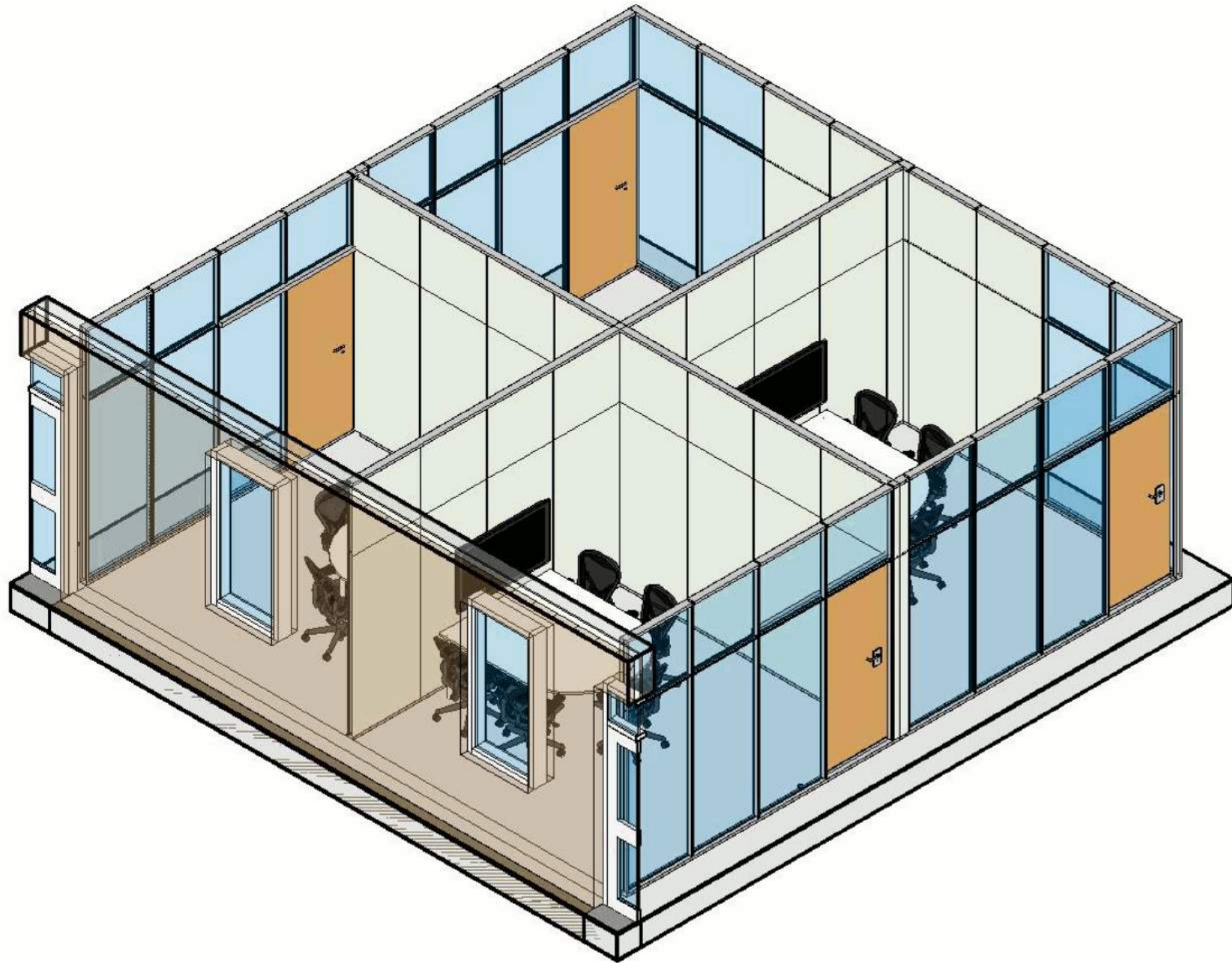

# NEXT STEPS

- Outdoor Learning / Plaza- Design Meeting 1
- Final Project Presentation to Steering Committee
- Design Draft Submission
- Final Study Submission

Questions?



**RRMM**  
**ARCHITECTS**



**Richard Bland College**  
of WILLIAM & MARY