



**Committee on Administration, Buildings & Grounds
Virginia Institute of Marine Science
September 25, 2014**

VIMS Campuses



Main campus, Gloucester Point:

- Located at the mouth of the York River
- ~42 Acres
- 67 Buildings
- 338,772 SF



Field Laboratory, Wachapreague:

- Located on the seaside of the Eastern Shore
- ~5 Acres
- 24 Buildings
- 34,026 SF



Kauffman Aquaculture Center, Topping:

- Located on the Rappahannock River
- 1 Building
- 6,420 SF



Gloucester Point Campus



Wachapreague Campus



Topping Campus





Construction Update

Next Generation Coastal Research Vessel Concept Design

designed for

VIMS | **WILLIAM
& MARY**
VIRGINIA INSTITUTE OF MARINE SCIENCE

designed by

JMS
NAVAL ARCHITECTS
SALVAGE ENGINEERS

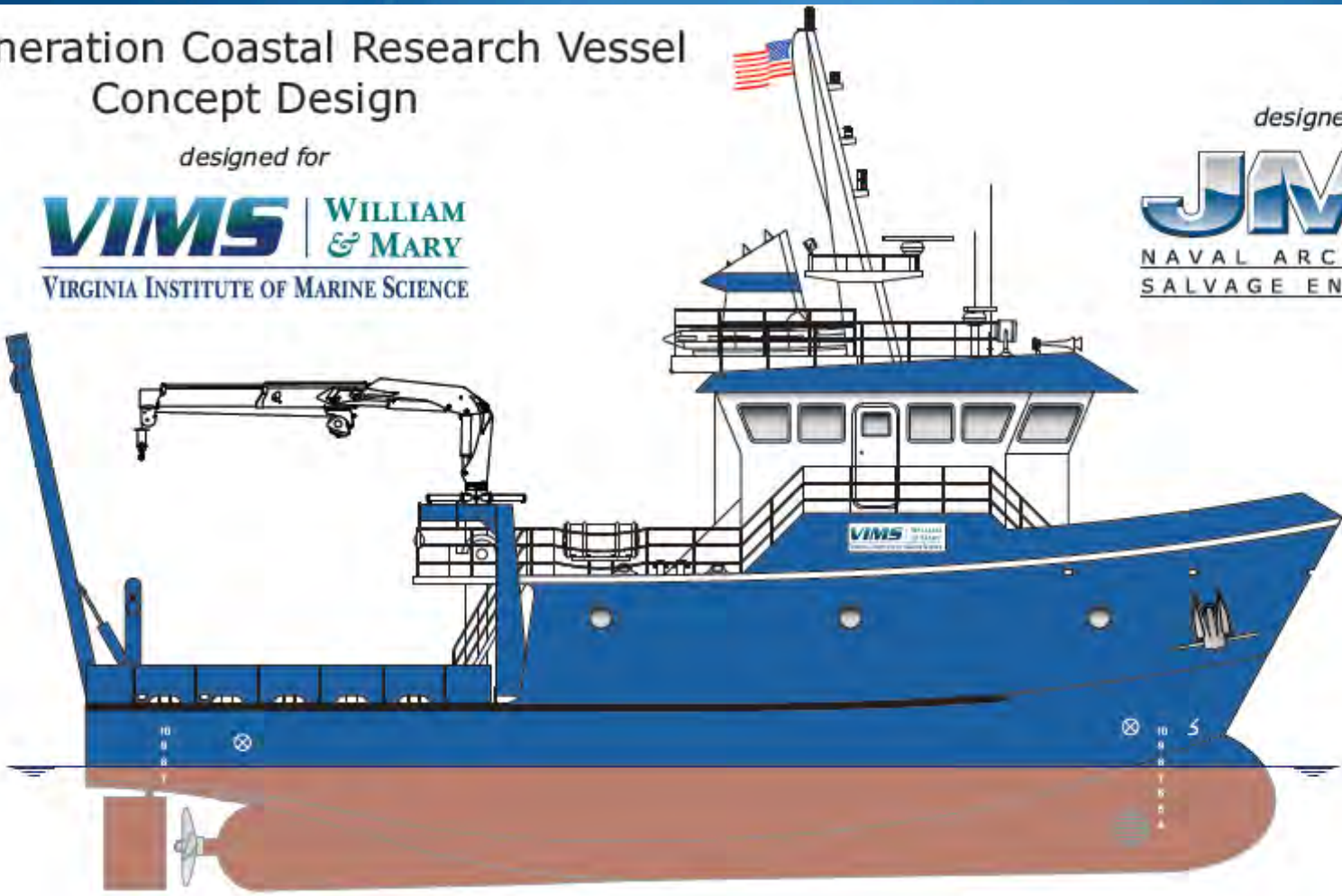

Principal Characteristics:

Length (overall)	80'-8"
Length (full load waterline)	76'-4"
Beam	26'-0"
Depth	12'-0"
Draft (lightship)	6'-8"
Draft (full load)	8'-1"
Displacement (lightship)	178.6 LT
Displacement (full load)	248.0 LT
Max Speed (full load in SS 4)	10.8 knots
Cruise (full load in SS 4)	10.0 knots

Propulsion

- One (1) x Baldor 746 kW propulsion motor at 1785 rpm
- One (1) x Twin Disc MGX 5321DC or MG540 gearbox
- One (1) x Fixed Pitch 5 blade propeller

Thrusters

- Two (2) x 110 kW Schottel SPJ 22 pump jets, in the stern
- One (1) x 100 kW Schottel STT 60 tunnel thruster in the bow

Generators

- Two (2) x CAT C18 variable speed diesels rated at 599 bkW, Coupled with Marathon 440 vac alternators rated at 550 ekW

Capacities

Fuel Oil	9,620 (gal)
Potable Water	3,200 (gal)

Accommodations

- Berthing 13 total (two 6-berth staterooms and one 1-berth stateroom)

Laboratories

Main	100 sqft
Wet	135 sqft
Aft Deck	710 sqft
Winch Deck	350 sqft

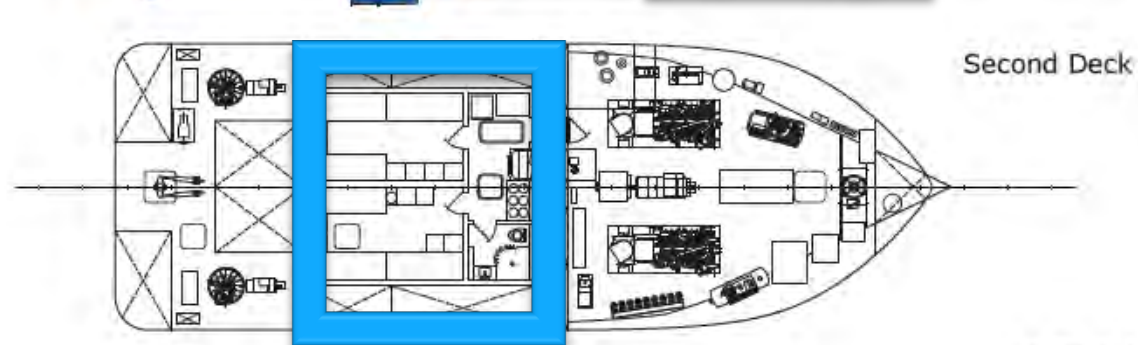
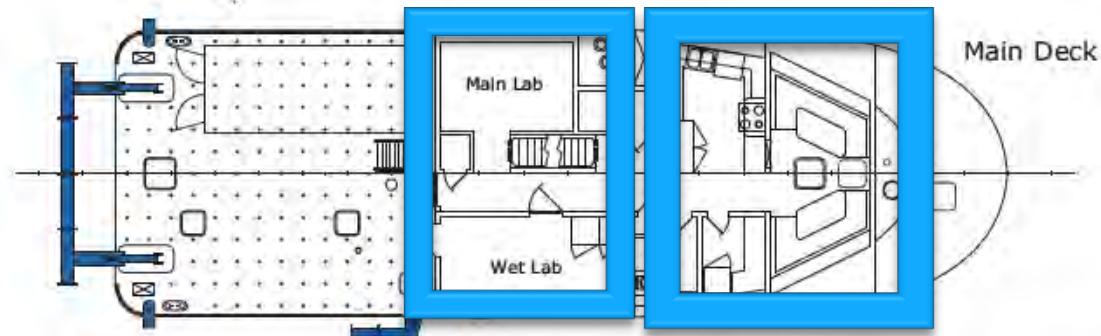
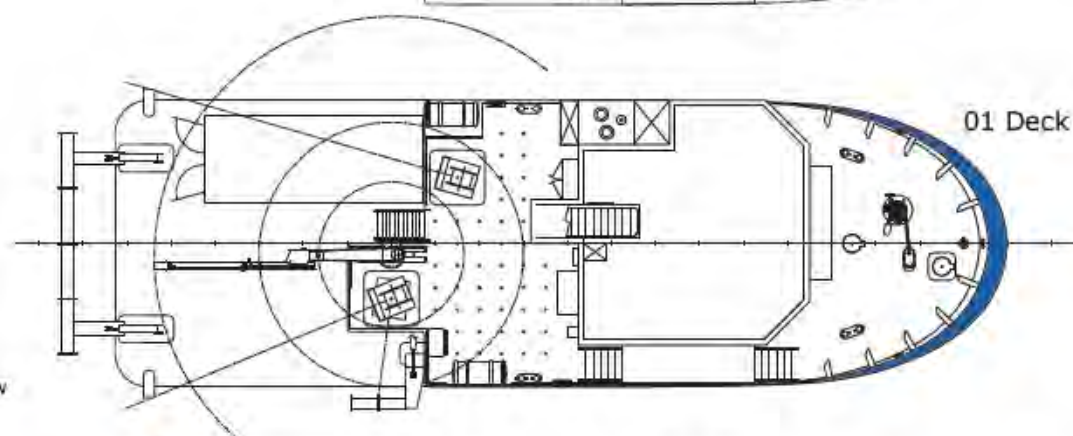
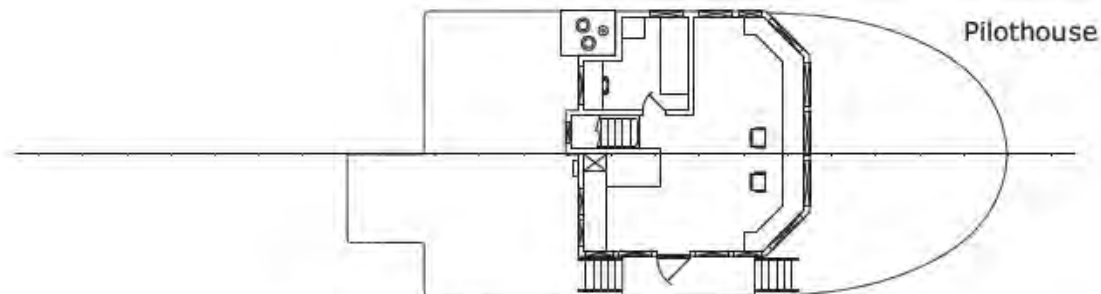

Future Construction



Consolidated Scientific Research Building



Consolidated Scientific Building

- Barton Malow Company selected as the Construction Manager
- Schematic design is complete and has been approved by the College's Design Review Board and the Art and Architectural Review Board in Richmond
- The project cost at schematic design is \$15M and square footage is 32,000

Consolidated Scientific Research Facility

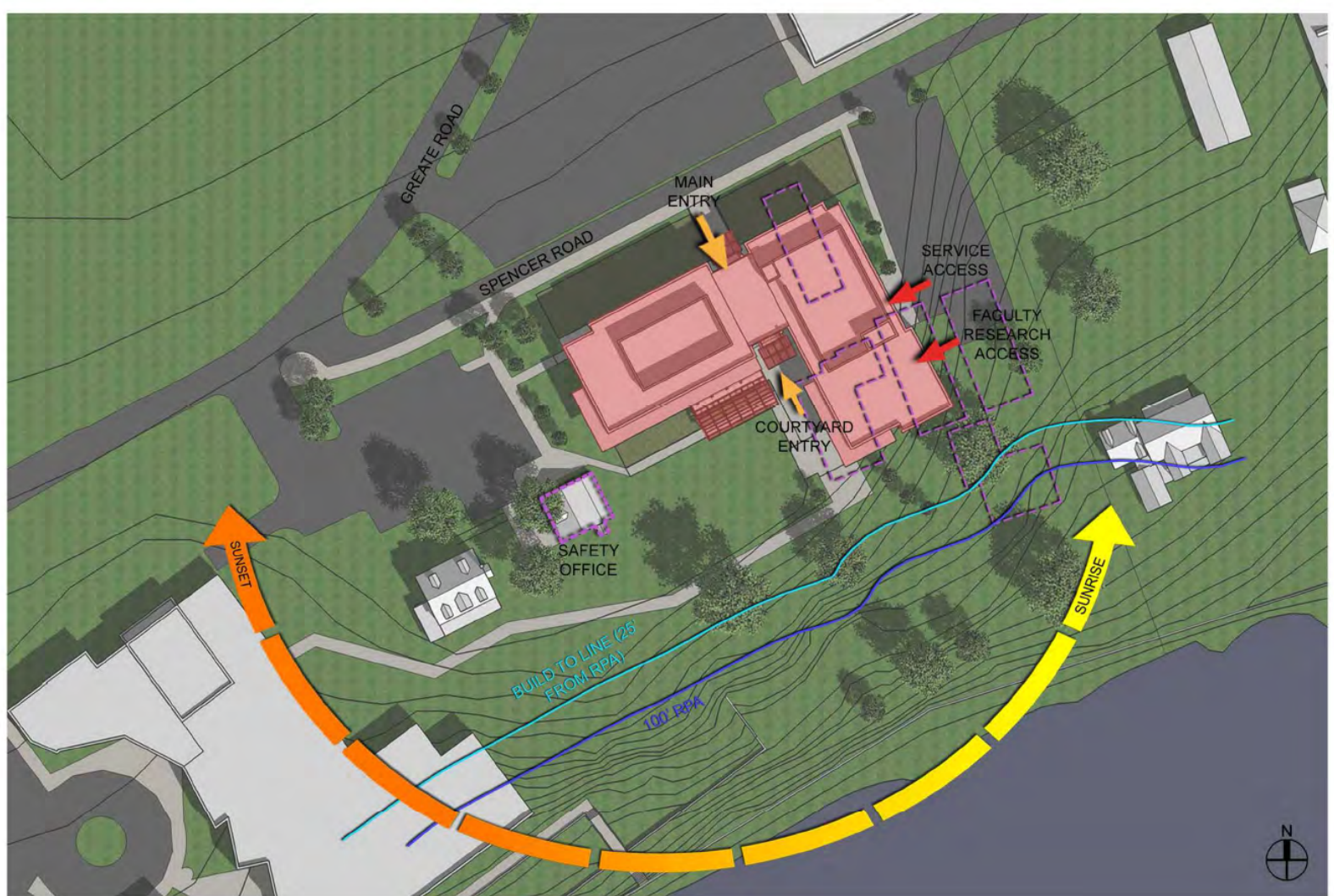

PRECINCT PLAN



PERSPECTIVE LOOKING SOUTHWEST



PERSPECTIVE LOOKING NORTHEAST



AERIAL FROM NORTHWEST

Facilities Management



Facilities Management Building

- RRMM Architects have completed the preplanning study
- VIMS will be submitting the contents of the study to DPB/BCOM in October
- Expected project cost is \$7.7M



PROPOSED SOUTHWEST VIEW



Oyster Hatchery

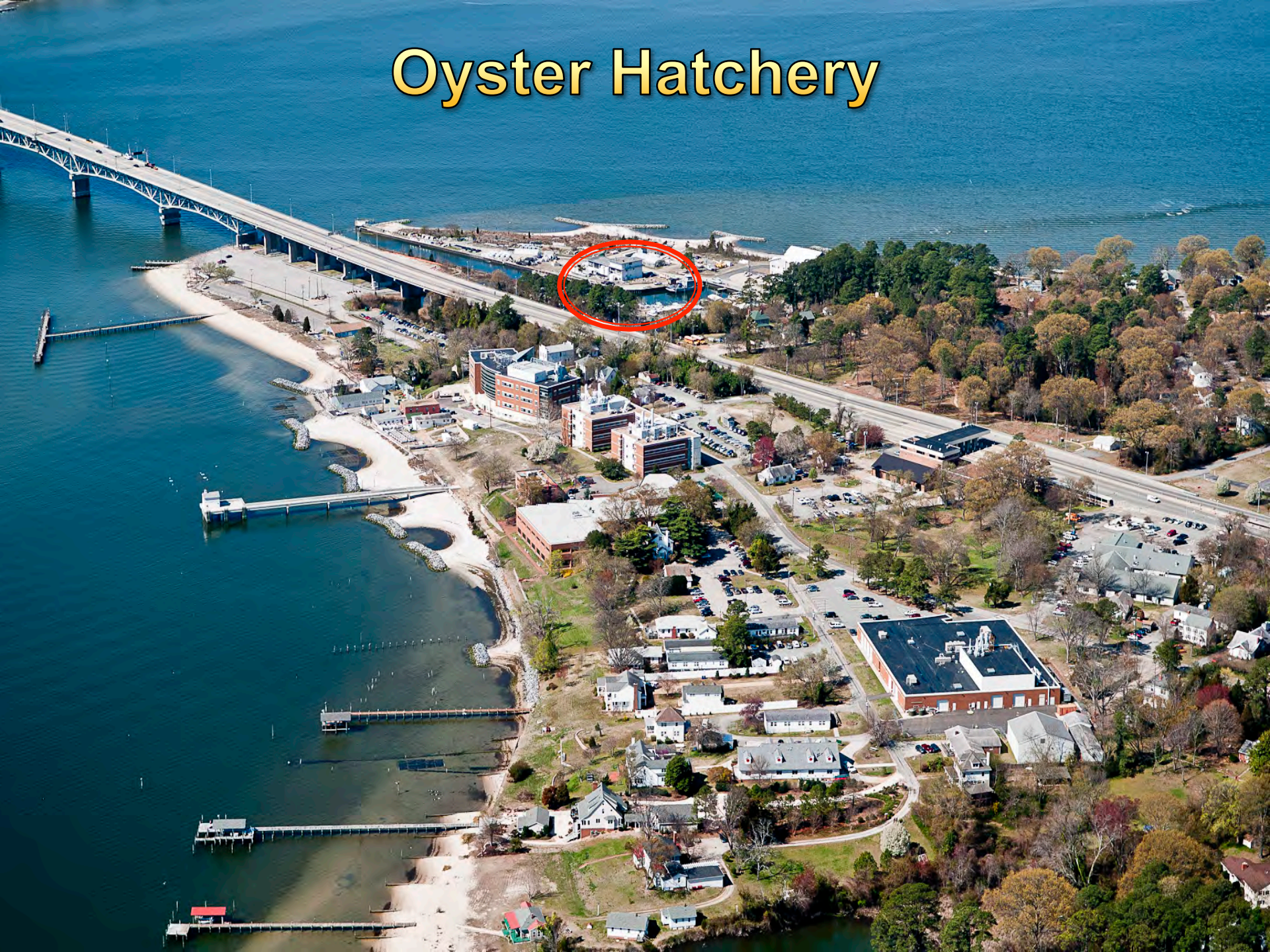

Resolution 9 For Approval

Demolition of Buildings

Questions?

