

Poplar Hall Fourth Floor Rooms

Poplar 401-410 & 418-424 – Typical Traditional Doubles

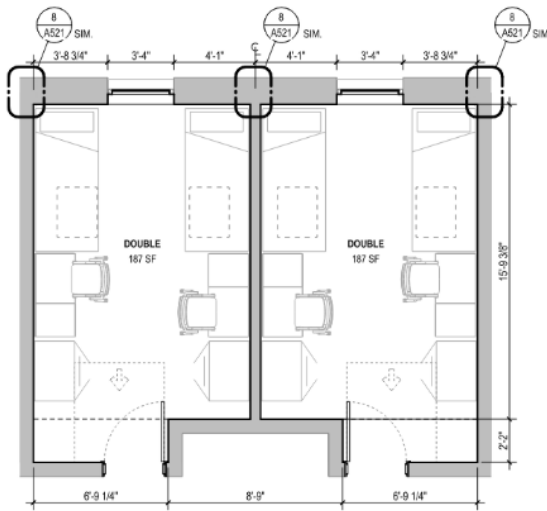

Room occupancy	2 occupants per bedroom
Bathroom Facilities	Hall Single User Bathrooms
Built in furniture	none
Air conditioned	yes
Note	Ceiling is slanted on the dormer window end of the room

Poplar 416 – Typical RA Rooms

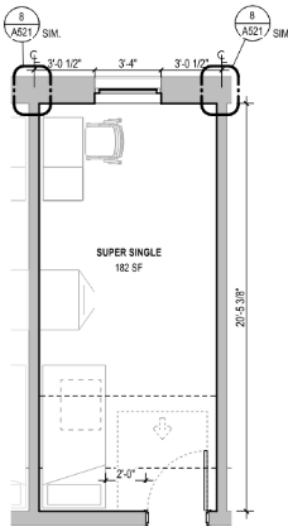

Room occupancy	1 occupant
Bathroom Facilities	Hall Single User Bathrooms
Built in furniture	none
Air conditioned	yes
Note	Ceiling is slanted on the dormer window end of the room

Floor plans are provided to demonstrate differences between room types. Individual rooms vary. All dimensions and square footage are approximate and should not be relied upon as representation, express or implied, of your actual assigned room.