

Dawson Hall First-Floor Rooms

Dawson 119, 127

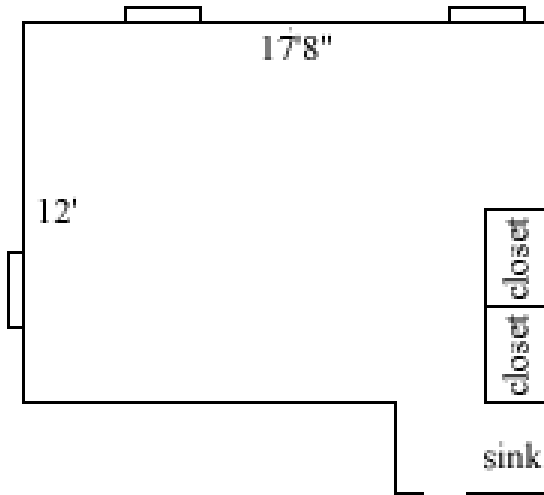

Room occupancy	2
Ceiling height	8'10"
# of outlets	4
Sink	yes
Bathroom Facilities	hall
Built in furniture	none
Medicine Cabinet	yes
Closet size	3' x 2'4"
Window size	5'6" x 3'8.5"
Air conditioned	yes

Dawson 120, 121

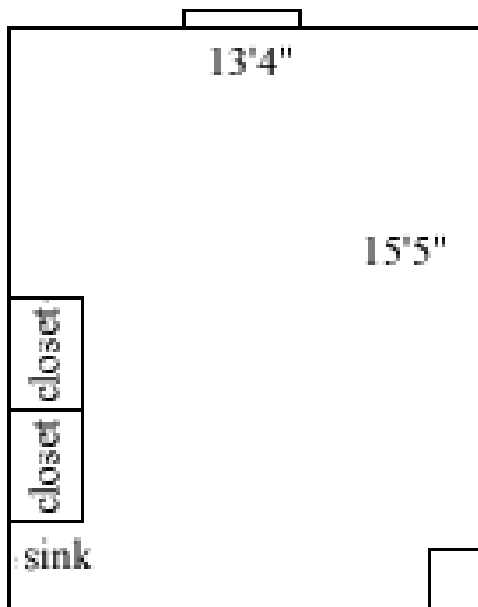

Room occupancy	2
Ceiling height	8'10"
# of outlets	4
Sink	yes
Bathroom Facilities	hall
Built in furniture	none
Medicine Cabinet	yes
Closet size	3' x 2'4"
Window size	5'6" x 3'8.5"
Air conditioned	yes

Floor plans are provided to demonstrate differences between room types. Individual rooms vary. All dimensions and square footage are approximate and should not be relied upon as representation, express or implied, of your actual assigned room.

Dawson Hall First-Floor Rooms

Dawson 122, 125

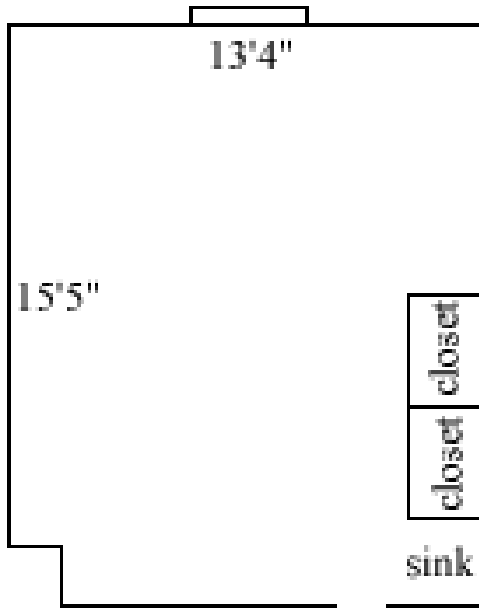

Room occupancy	2
Ceiling height	8'10"
# of outlets	4
Sink	yes
Bathroom Facilities	hall
Built in furniture	none
Medicine Cabinet	yes
Closet size	3' x 2'4"
Window size	5'6" x 3'8.5"
Air conditioned	yes

Dawson 123, 124

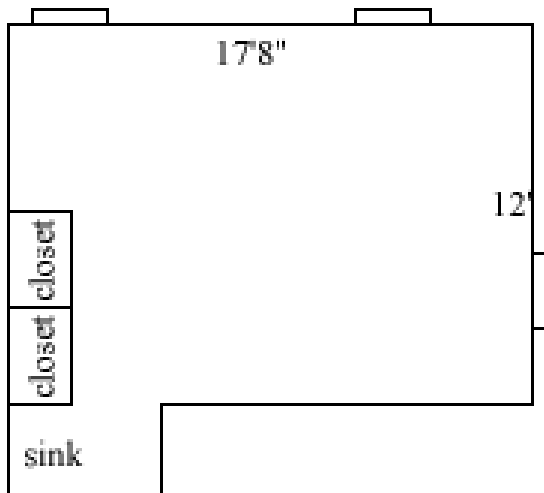

Room occupancy	2
Ceiling height	8'10"
# of outlets	4
Sink	yes
Bathroom Facilities	hall
Built in furniture	none
Medicine Cabinet	yes
Closet size	3' x 2'4"
Window size	5'6" x 3'8.5"
Air conditioned	yes

Floor plans are provided to demonstrate differences between room types. Individual rooms vary. All dimensions and square footage are approximate and should not be relied upon as representation, express or implied, of your actual assigned room.

Dawson Hall First-Floor Rooms

Dawson 126

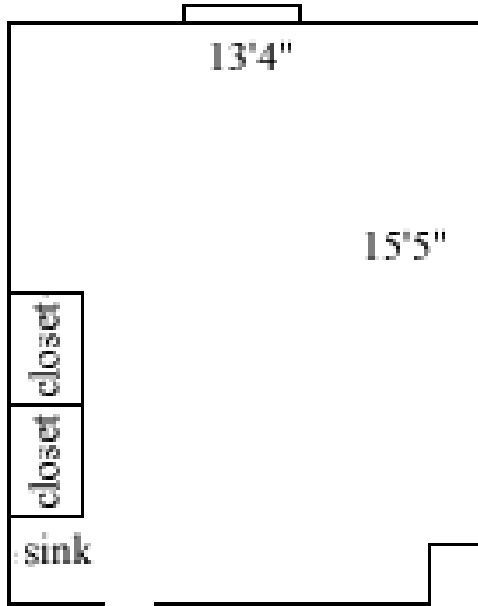

Room occupancy	1
Ceiling height	8'10"
# of outlets	4
Sink	yes
Bathroom Facilities	hall
Built in furniture	none
Medicine Cabinet	yes
Closet size	3' x 2'4"
Window size	5'6" x 3'8.5"
Air conditioned	yes

Floor plans are provided to demonstrate differences between room types. Individual rooms vary. All dimensions and square footage are approximate and should not be relied upon as representation, express or implied, of your actual assigned room.