

## Barrett Hall 2<sup>nd</sup> Floor Rooms

### Barrett 201, 234

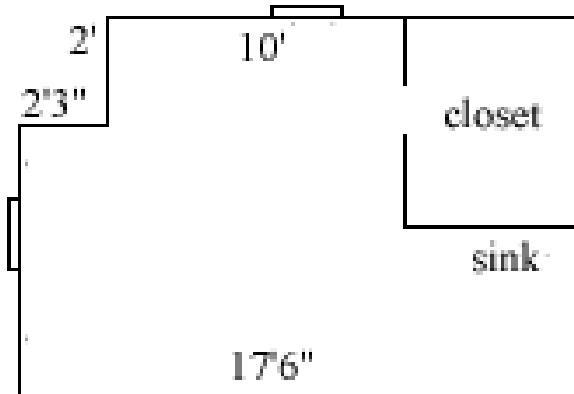

|                     |                      |
|---------------------|----------------------|
| Room occupancy      | 2                    |
| Ceiling height      | 2nd - 9'             |
|                     | 3rd - 9'8"           |
| # of outlets        | 7                    |
| Sink                | yes                  |
| Bathroom facilities | hall                 |
| Built in furniture  | none                 |
| Medicine cabinet    | yes                  |
| Closet size         | 4'8" (d) x 7'10" (w) |
| Window size         | 5'9" (h) x 3'8"(w)   |

### Barrett 202, 235

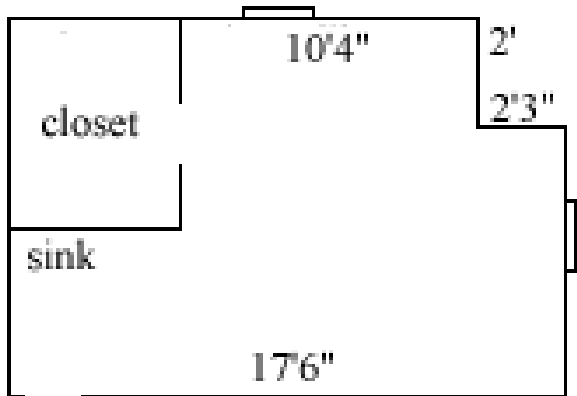

|                     |                     |
|---------------------|---------------------|
| Room occupancy      | 2                   |
| Ceiling height      | 2nd - 9'            |
|                     | 3rd - 9'8"          |
| # of outlets        | 7                   |
| Sink                | yes                 |
| Bathroom facilities | hall                |
| Built in furniture  | none                |
| Medicine cabinet    | yes                 |
| Closet size         | 4'6" (d) x 7'6" (w) |
| Window size         | 5'9" (h) x 3'8"(w)  |

Floor plans are provided to demonstrate differences between room types. Individual rooms vary. All dimensions and square footage are approximate and should not be relied upon as representation, express or implied, of your actual assigned room.

## Barrett Hall 2<sup>nd</sup> Floor Rooms

### Barrett 203, 214

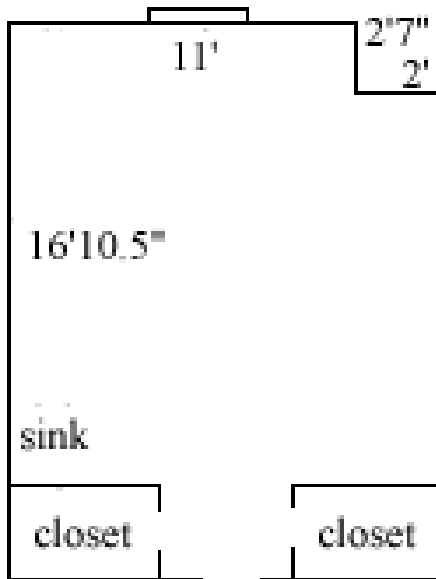

|                     |                                     |
|---------------------|-------------------------------------|
| Room occupancy      | 2                                   |
| Ceiling height      | 1st - 10'<br>2nd - 9'<br>3rd - 9'8" |
| # of outlets        | 5                                   |
| Sink                | yes                                 |
| Bathroom facilities | hall                                |
| Built in furniture  | none                                |
| Medicine cabinet    | yes                                 |
| Closet size         | 4' (d) x 2'6" (w)                   |
| Window size         | 5'9" (h) x 3'8" (w)                 |

### Barrett 204, 222, 233

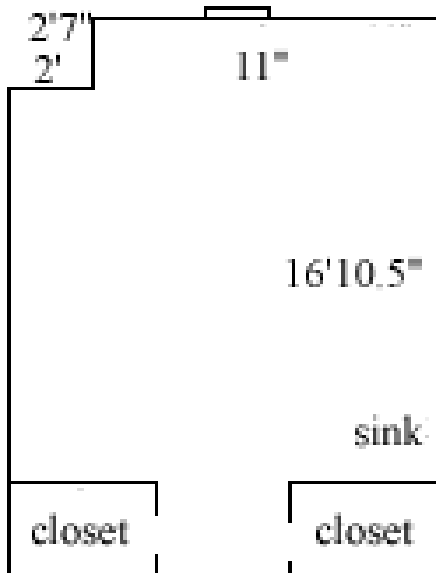

|                     |                                     |
|---------------------|-------------------------------------|
| Room occupancy      | 2                                   |
| Ceiling height      | 1st - 10'<br>2nd - 9'<br>3rd - 9'8" |
| # of outlets        | 5                                   |
| Sink                | yes                                 |
| Bathroom facilities | hall                                |
| Built in furniture  | none                                |
| Medicine cabinet    | yes                                 |
| Closet size         | 4' (d) x 2'6" (w)                   |
| Window size         | 5'9" (h) x 3'8" (w)                 |

Floor plans are provided to demonstrate differences between room types. Individual rooms vary. All dimensions and square footage are approximate and should not be relied upon as representation, express or implied, of your actual assigned room.

## Barrett Hall 2<sup>nd</sup> Floor Rooms

### Barrett 205, 208, 209, 213, 225, 226, 229, 230

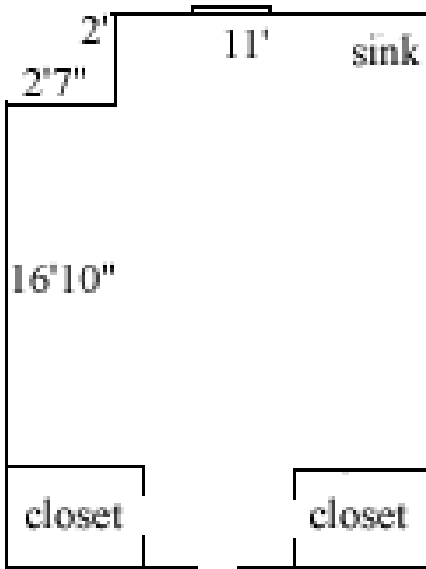

|                     |                     |
|---------------------|---------------------|
| Room occupancy      | 2                   |
| Ceiling height      | 1st - 10'           |
|                     | 2nd - 9'            |
|                     | 3rd - 9'8"          |
| # of outlets        | 6                   |
| Sink                | yes                 |
| Bathroom facilities | hall                |
| Built in furniture  | none                |
| Medicine cabinet    | yes                 |
| Closet size         | 4' (d) x 2'6" (w)   |
| Window size         | 5'9" (h) x 3'8" (w) |

### Barrett 206, 207, 210, 211, 212, 223, 224, 227, 228, 231

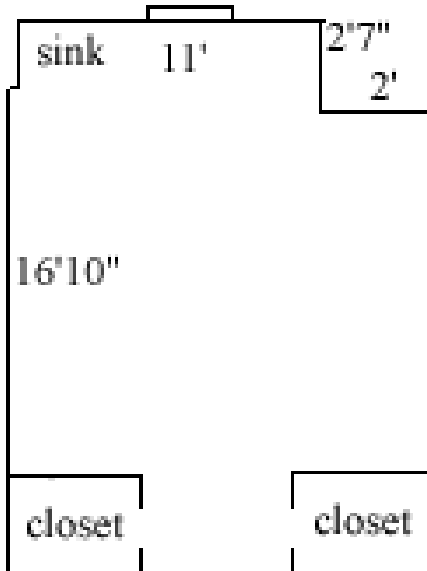

|                     |                     |
|---------------------|---------------------|
| Room occupancy      | 2                   |
| Ceiling height      | 1st - 10'           |
|                     | 2nd - 9'            |
|                     | 3rd - 9'8"          |
| # of outlets        | 6                   |
| Sink                | yes                 |
| Bathroom facilities | hall                |
| Built in furniture  | none                |
| Medicine cabinet    | yes                 |
| Closet size         | 3'6" (d) x 3'6" (w) |
| Window size         | 5'9" (h) x 3'8" (w) |

Floor plans are provided to demonstrate differences between room types. Individual rooms vary. All dimensions and square footage are approximate and should not be relied upon as representation, express or implied, of your actual assigned room.

## Barrett Hall 2<sup>nd</sup> Floor Rooms

### Barrett 215

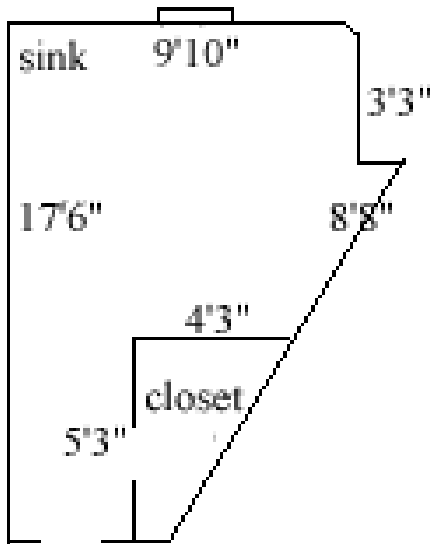

|                     |                        |
|---------------------|------------------------|
| Room occupancy      | 1                      |
| Ceiling height      | 2nd - 9'<br>3rd - 9'8" |
| # of outlets        | 5                      |
| Sink                | yes                    |
| Bathroom facilities | hall                   |
| Built in furniture  | none                   |
| Medicine cabinet    | yes                    |
| Closet size         | 5'3" (d) x 4'3" (w)    |
| Window size         | 5'9" (h) x 3'8" (w)    |

### Barrett 216

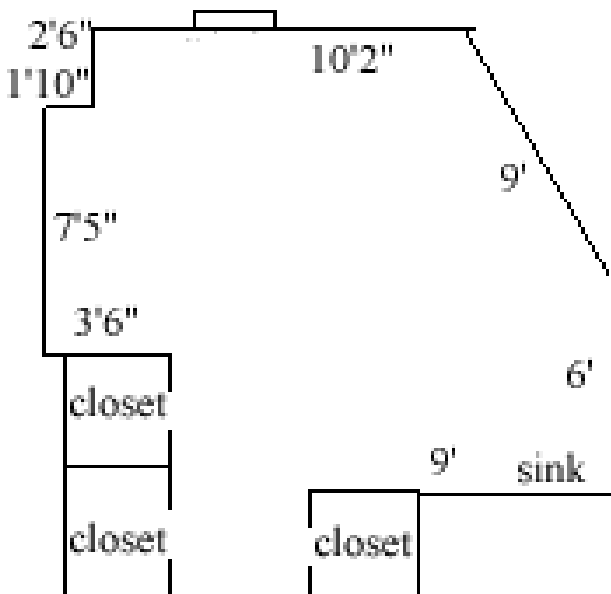

|                     |                     |
|---------------------|---------------------|
| Room occupancy      | 2                   |
| Ceiling height      | 9'                  |
| # of outlets        | 6                   |
| Sink                | yes                 |
| Bathroom facilities | hall                |
| Built in furniture  | none                |
| Medicine cabinet    | yes                 |
| Closet size         | 3' (d) x 3' (w)     |
| Window size         | 5'9" (h) x 3'8" (w) |

Floor plans are provided to demonstrate differences between room types. Individual rooms vary. All dimensions and square footage are approximate and should not be relied upon as representation, express or implied, of your actual assigned room.

## Barrett Hall 2<sup>nd</sup> Floor Rooms

### Barrett 217

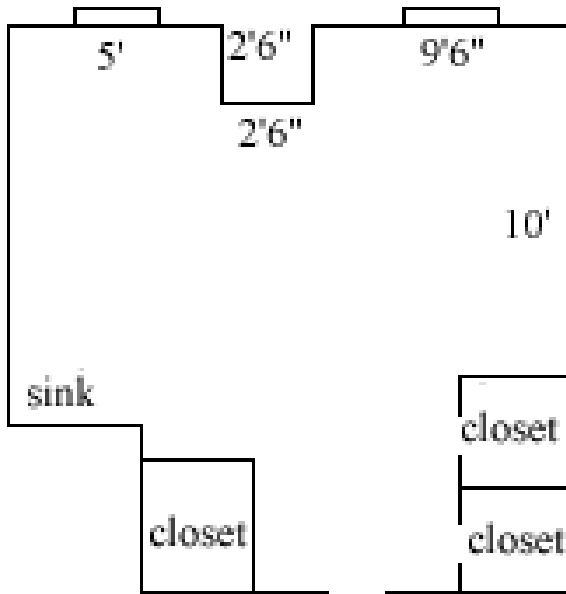

|                     |                     |
|---------------------|---------------------|
| Room occupancy      | 2                   |
| Ceiling height      | 9'                  |
| # of outlets        | 5                   |
| Sink                | yes                 |
| Bathroom facilities | hall                |
| Built in furniture  | none                |
| Medicine cabinet    | yes                 |
| Closet size         | 3'8" (d) x 3'6" (w) |
| Window size         | 5'9" (h) x 3'8" (w) |

### Barrett 219

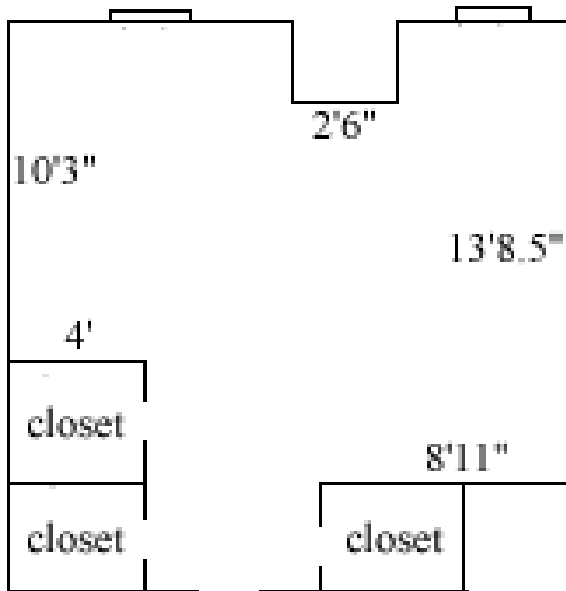

|                     |                        |
|---------------------|------------------------|
| Room occupancy      | 2                      |
| Ceiling height      | 2nd - 9'<br>3rd - 9'8" |
| # of outlets        | 7                      |
| Sink                | yes                    |
| Bathroom facilities | hall                   |
| Built in furniture  | none                   |
| Medicine cabinet    | yes                    |
| Closet size         | 3'6" (d) x 2'6" (w)    |
| Window size         | 5'9" (h) x 3'8" (w)    |

Floor plans are provided to demonstrate differences between room types. Individual rooms vary. All dimensions and square footage are approximate and should not be relied upon as representation, express or implied, of your actual assigned room.

## Barrett Hall 2<sup>nd</sup> Floor Rooms

### Barrett 220

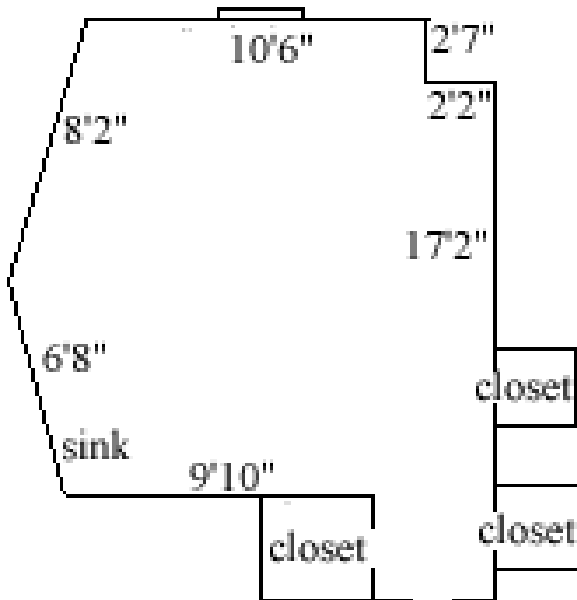

|                     |                     |
|---------------------|---------------------|
| Room occupancy      | 2                   |
| Ceiling height      | 9'                  |
| # of outlets        | 7                   |
| Sink                | yes                 |
| Bathroom facilities | hall                |
| Built in furniture  | none                |
| Medicine cabinet    | yes                 |
| Closet size         | 3'3" (d) x 3'3" (w) |
| Window size         | 5'9" (h) x 3'8" (w) |

### Barrett 221

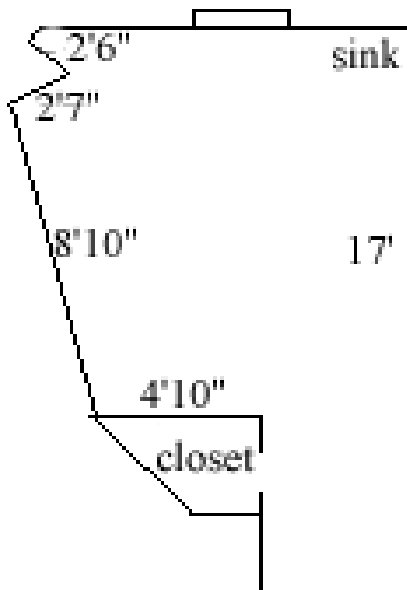

|                     |                        |
|---------------------|------------------------|
| Room occupancy      | 1                      |
| Ceiling height      | 2nd - 9'<br>3rd - 9'8" |
| # of outlets        | 7                      |
| Sink                | yes                    |
| Bathroom facilities | hall                   |
| Built in furniture  | none                   |
| Medicine cabinet    | yes                    |
| Closet size         | 4'2" (d) x 4'9" (w)    |
| Window size         | 5'9" (h) x 3'8" (w)    |

Floor plans are provided to demonstrate differences between room types. Individual rooms vary. All dimensions and square footage are approximate and should not be relied upon as representation, express or implied, of your actual assigned room.

## Barrett Hall 2<sup>nd</sup> Floor Rooms

### Barrett 232

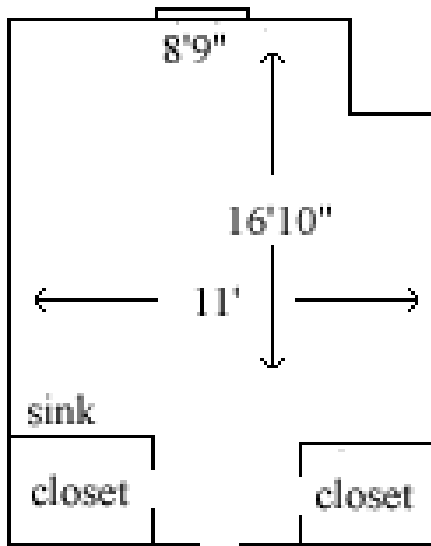

|                     |                        |
|---------------------|------------------------|
| Room occupancy      | 2                      |
| Ceiling height      | 2nd - 9'<br>3rd - 9'8" |
| # of outlets        | 7                      |
| Sink                | yes                    |
| Bathroom facilities | hall                   |
| Built in furniture  | none                   |
| Medicine cabinet    | yes                    |
| Closet size         | 3'2" (d) x 2'10" (w)   |
| Window size         | 5'9" (h) x 3'8" (w)    |

Floor plans are provided to demonstrate differences between room types. Individual rooms vary. All dimensions and square footage are approximate and should not be relied upon as representation, express or implied, of your actual assigned room.