

## Setting up Eduroam - Android

This document will cover downloading and installing the SecureW2 certificate installer for Eduroam. **Because each Android version is different, images and menus may be different.**

1. Download and install the SecureW2 JoinNow application
2. Install the Eduroam certificate

### Download and install the SecureW2 JoinNow application

In the Chrome browser,  
visit

<https://connect.wm.edu>

Click 'Begin Eduroam  
Setup'

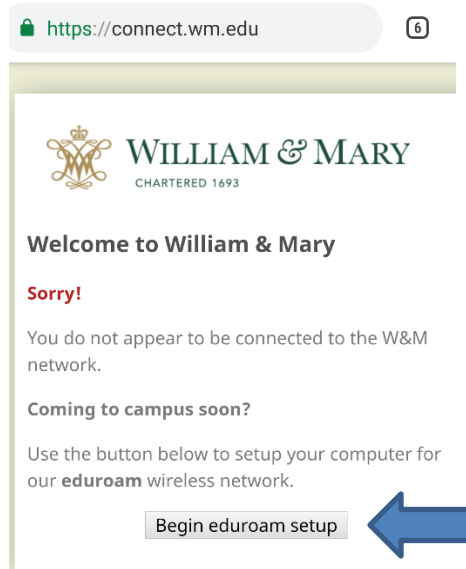

The screenshot shows a web browser window with the URL <https://connect.wm.edu>. The page features the William & Mary logo and the text "Welcome to William & Mary". Below this, it says "Sorry!" and "You do not appear to be connected to the W&M network." There is a section titled "Coming to campus soon?" with the text "Use the button below to setup your computer for our eduroam wireless network." A button labeled "Begin eduroam setup" is visible, with a blue arrow pointing to it from the right.

Check that Android is  
selected as your device  
type.

Choose 'Download  
Configuration App'

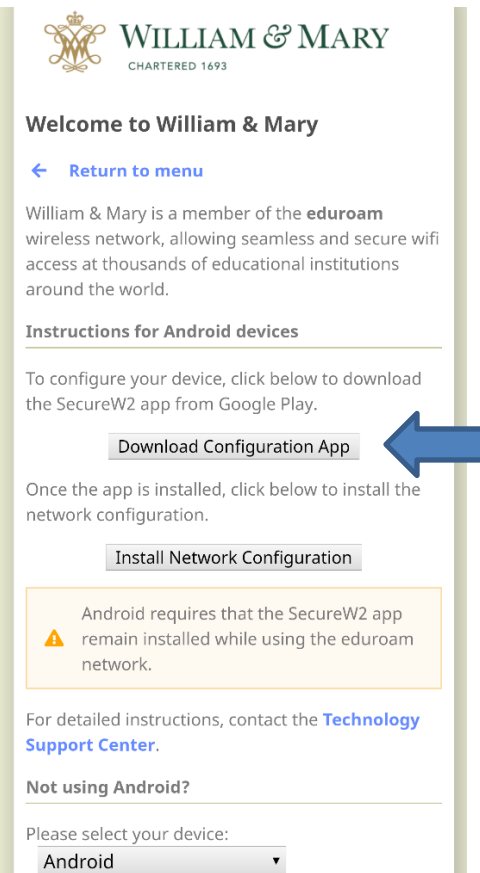

The screenshot shows the same William & Mary Connect page. It includes a "Return to menu" link, a paragraph about the eduroam network, and a section titled "Instructions for Android devices" which says "To configure your device, click below to download the SecureW2 app from Google Play." A button labeled "Download Configuration App" is highlighted with a blue arrow pointing to it from the right. Below this, there is another button labeled "Install Network Configuration" and a warning box stating "Android requires that the SecureW2 app remain installed while using the eduroam network." At the bottom, there is a "Not using Android?" section and a dropdown menu for "Please select your device:" with "Android" selected.

Install 'SecureW2 JoinNow'

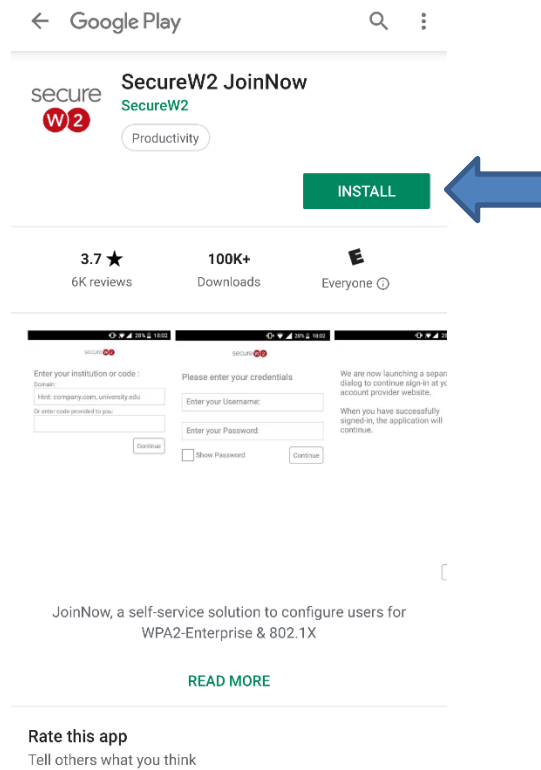

**Install the Eduroam Certificate**

Once downloaded, the application will automatically open.  
 (If the application does not open automatically, visit <https://connect.wm.edu> from Chrome and click the 'Install Network Configuration' button.)

Click **Next**

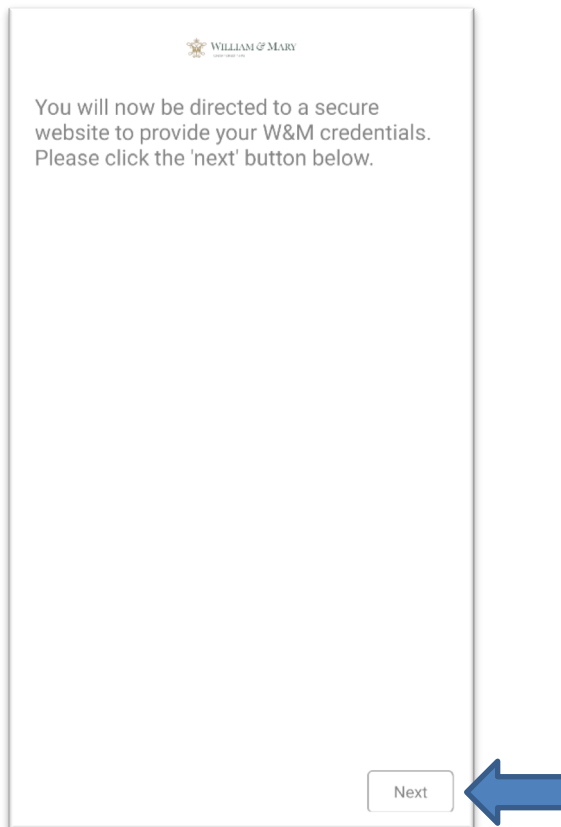

Enter your Banner (CAS) credentials. Click login.

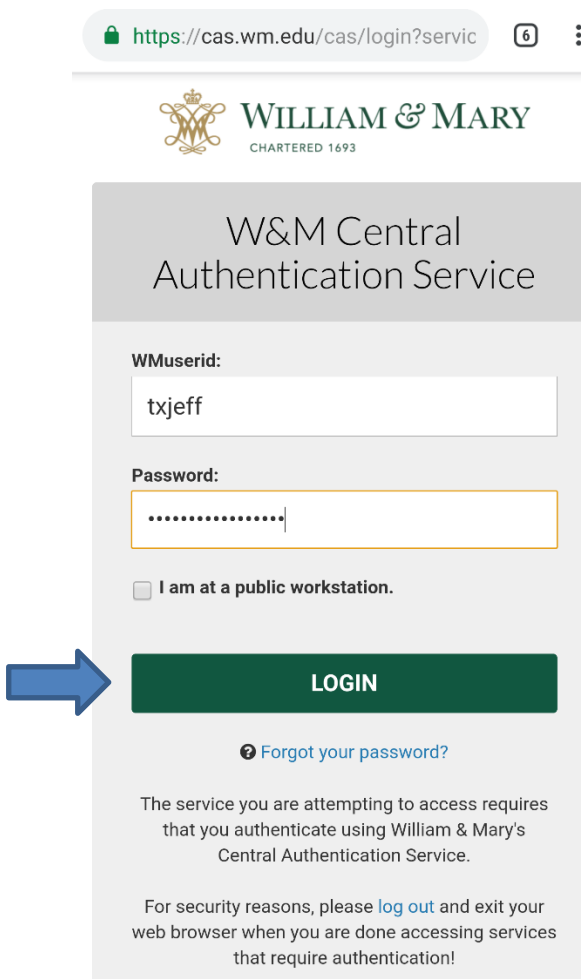

You will receive a notice that you are 'successfully connected to: eduroam'

Click 'Done'

